

## Installation instructions for Ancon QwikFix Threaded Inserts

This installation instruction is for all Threaded Inserts as listed in the table below. For the design of Threaded Inserts please refer to the Ancon Threaded Insert Design Guide available on [www.ancon.com.au](http://www.ancon.com.au).

**Table 1 – Product Overview Ancon QwikFix (Product Code FER)**

| Thread | Length [mm] |                      |
|--------|-------------|----------------------|
|        | 76          | 96                   |
| M12    |             | FER1296Z<br>FER1296G |
|        | FER1676Z    | FER1696Z<br>FER1696G |
| M20    | FER2076Z    | FER2096Z<br>FER2096G |
|        |             | FERB3496Z            |



Product finishes:

Z / ZH: Zinc Plated

G: Hot-dip galvanized

**1A** Installation of QwikFix Threaded inserts with Nailing Plate



For Threaded Inserts that are installed to the edge or bottom of timber formwork it is recommend to use Ancon NP nailing plates to attach the Threaded Insert to the formwork.

**Table 2 – Product Overview Ancon Nailing Plates (Product Code NP)**

| Thread       | M10    | M12   | M16   | M20   | M24    | ¾" Unicoil |
|--------------|--------|-------|-------|-------|--------|------------|
| Product code | NP10U  | NP12U | NP16U | NP20U | NP24U  | NPB134     |
| colour       | Purple | Red   | Green | Blue  | Yellow | Red        |

1. Attach the Nailing plate to the Threaded Insert



## Installation of QwikFix Threaded Inserts

- Nail the Threaded Insert to the formwork

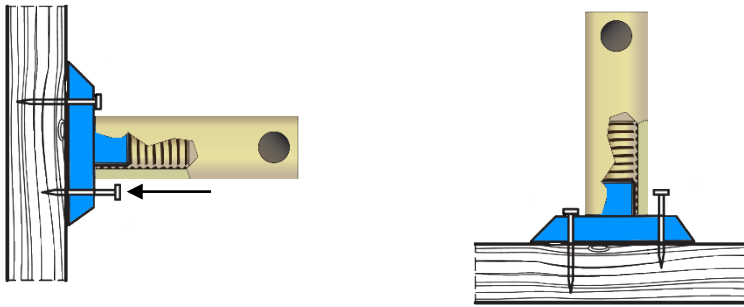

- Install reinforcement bars as required.

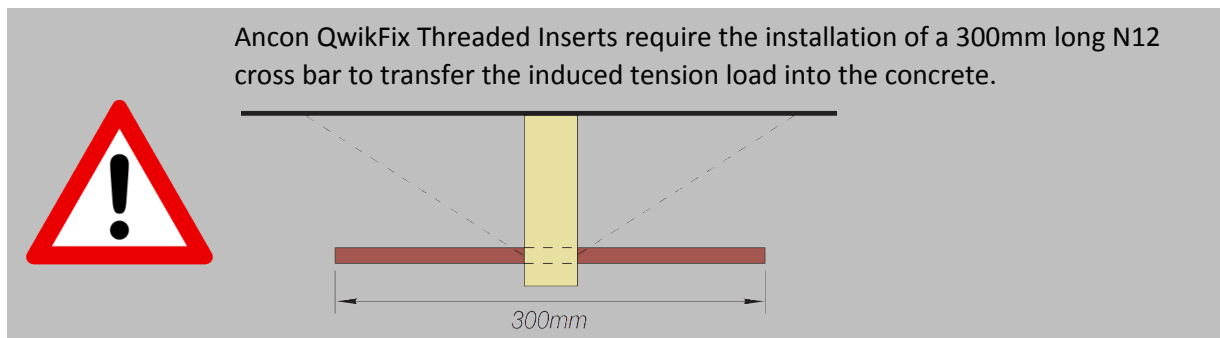

1B

Installation of QwikFix Threaded inserts with Ancon Super Chair and Antenna Plate or Nailing Plate

- Choose the right Super Chair for the application based on slab thickness and QwikFix Threaded Insert as per table 3 below. Super Chairs allow for two different panel thicknesses by simply rotating the chair 90 degrees. Super chair can be used with 96mm long QwikFix threaded inserts only.

**Table 3 – Product Overview Ancon Super Chair (Product Code SC)**

| Slab thickness [mm] | Product code SC Precast Chair for use with 96-mm QwikFix |
|---------------------|--|
| 125                 | SC125150   |
| 150                 | SC125150/SC150175  |
| 175                 | SC150175/SC175200  |
| 200                 | SC175200   |

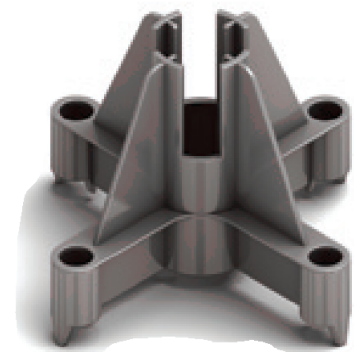

## Installation of QwikFix Threaded Inserts

2. Insert a 300mm long N12 bar through the cross hole and then put the QwikFix with bar into the Super Chair. Two different panel thicknesses can be achieved by rotating the chair 90 degrees.

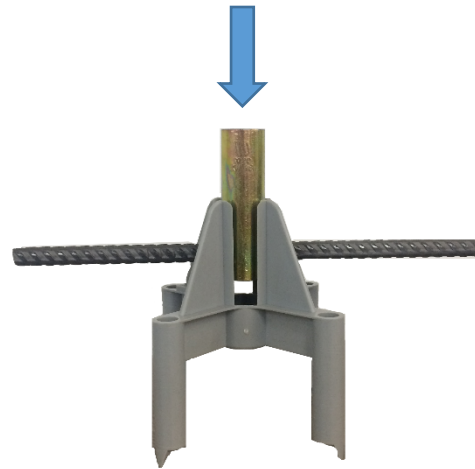
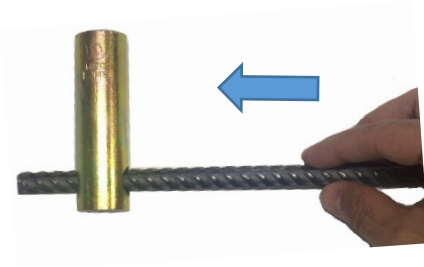

3. Attach the Antenna cap or nailing plate to the top of the QwikFix Threaded Insert.

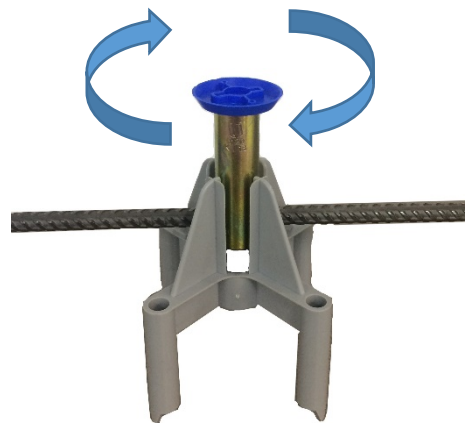
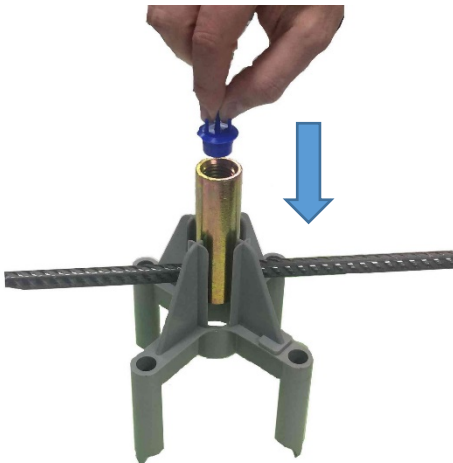

When using the nailing plate it is recommend to apply grease to the base of the nailing plate.

4. Place QwikFix Threaded Insert at the specified location and fix the cross-bar to the reinforcement to avoid displacement of the Insert during concrete pour.

2

Concrete Placement



Special care is required during the compaction of the concrete around the threaded insert to avoid honeycombing and voids around the Threaded Insert.

## Installation of QwikFix Threaded Inserts

3a

Bolt Installation for metric Threaded Inserts

Ancon QwikFix Threaded Inserts are designed to exceed the tensile and shear capacity of a grade 4.6 bolt. Ancon recommends to use the Threaded inserts with bolts of this grade. If bolts of a higher grade are installed, the torque must be limited to the installation torque of a grade 4.6 bolt to avoid possible damage to the Threaded Insert and surrounding concrete.

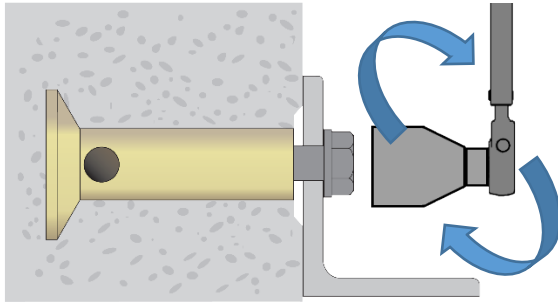

Install the bolt using a calibrated torque wrench with the torque limited to the value shown in the table below.

**Table 4 – Installation torques for metric bolts with Ancon QwikFoot and QwikFix Threaded Inserts:**

| Bolt Size | Installation Torque [Nm] |
|-----------|--------------------------|
| M10       | 18                       |
| M12       | 31                       |
| M16       | 75                       |
| M20       | 150                      |
| M24       | 250                      |



Electric and air operated Impact Wrenches (so called rattle guns) apply uncontrolled torque to the bolt which can cause damage to bolt, Threaded Insert and supporting concrete.

Ancon recommends the use of torque-limited wrenches for the installation of bolts in Threaded Inserts.

Threaded Inserts require a minimum thread engagement of 1.5 times the thread diameter.

3b

Installation of Unicoil bolts in Unicoil Threaded Inserts for temporary support according to AS 3850

The bolt should be installed using a calibrated torque wrench with the torque limited to the value shown in the table below.

Installation torque for Unicoil bolts used with Ancon QwikFoot and QwikFix Threaded Inserts:

| Bolt Size       | Installation Torque [Nm] |
|-----------------|--------------------------|
| ¾" Unicoil Bolt | 100                      |



## **AUSTRALIA**

### **Head Office, Sydney**

98 Kurrajong Avenue  
Mount Druitt  
Sydney  
NSW 2770  
Australia  
Tel: 1300 304 320  
Fax: +61 (0) 2 9675 3390

### **Brisbane**

4/15 Terrace Place  
Murarrie  
Brisbane  
QLD 4172  
Australia  
Tel: 1300 304 320  
Fax: +61 (0) 7 3395 6693

### **Melbourne**

9/63-69 Pipe Road  
Laverton North  
Melbourne  
VIC 3020  
Australia  
Tel: 1300 304 320  
Fax: +61 (0) 3 9311 1777

### **Perth**

18 Tennant Street  
Welshpool  
Perth  
WA 6106  
Australia  
Tel: 1300 304 320  
Fax: +61 (0) 8 9361 1262

**Email: [info@ancon.com.au](mailto:info@ancon.com.au)**

**Web: [www.ancon.com.au](http://www.ancon.com.au)**

## **NEW ZEALAND**

### **Christchurch**

2/19 Nuttal Drive  
Hillsborough  
Christchurch 8022  
New Zealand  
Tel: +64 (0) 3 376 5205  
Fax: +64 (0) 3 376 5206

### **Auckland**

246D James Fletcher Drive  
Otahuhu  
Auckland 2024  
New Zealand  
Tel: +64 (0) 9 276 2236  
Fax: +64 (0) 9 276 2237

**Email: [info@ancon.co.nz](mailto:info@ancon.co.nz)**

**Web: [www.ancon.co.nz](http://www.ancon.co.nz)**