

Installation Guide DSD/DSDQ/ESD/ESDQ

1 Nail sleeve to formwork. Do not remove sticky label, this prevents ingress of concrete into the sleeve

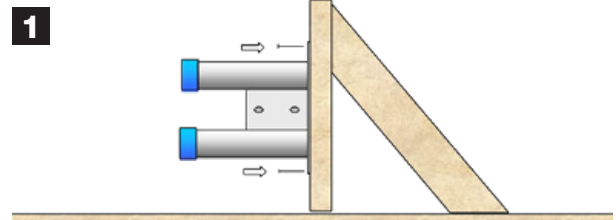

2 Fix the local reinforcement around the sleeve and pour the concrete

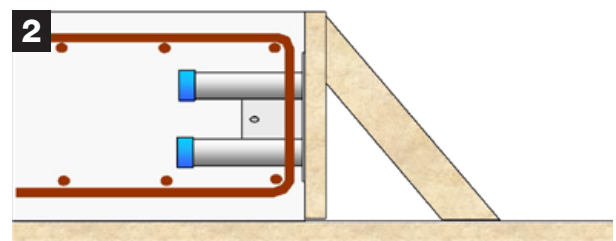

3 When the concrete has achieved sufficient strength, strike shuttering and peel off or puncture the label

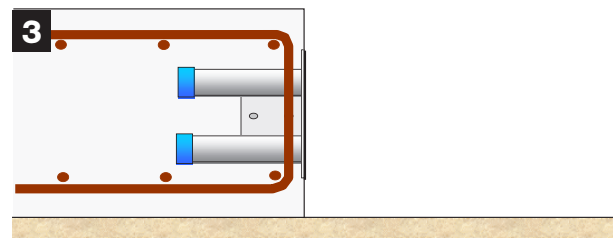

4 Position compressible joint filler

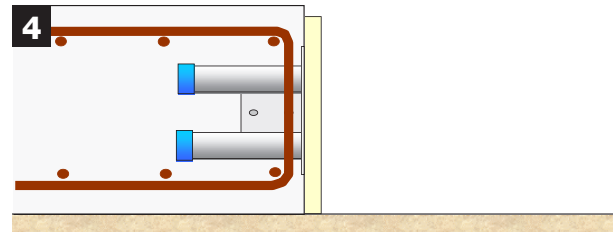

5 Push the dowel component through the filler until it is fully located in the sleeve

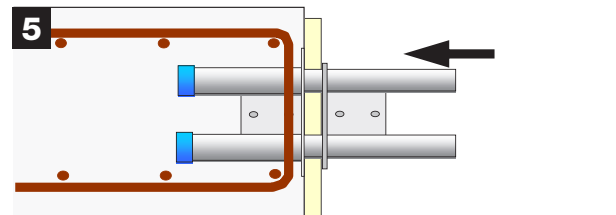

6 Fix the local reinforcement around the sleeve and pour the concrete

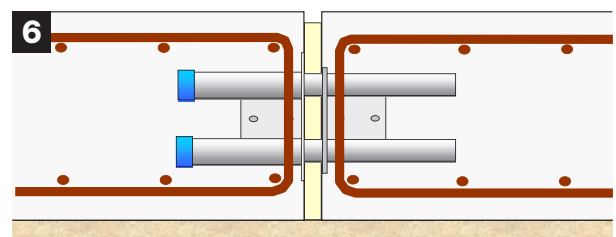

© Leviat, 2020

The Construction applications and details provided in this guide are indicative only. In every case installation should be entrusted to appropriately qualified and experienced persons. Normal handling precautions should be taken to avoid physical injury. Leviat cannot be held responsible for any injury as a result of using our products, unless such injury arises as a result of our negligence.